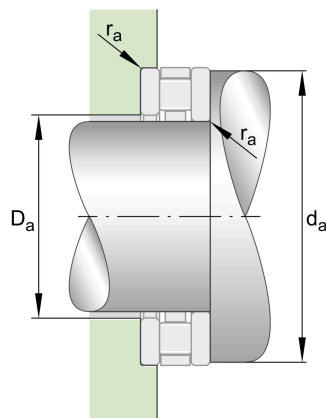
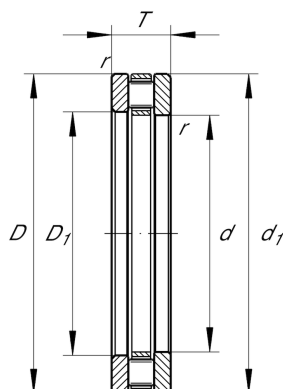
**81110-TV**

Axial cylindrical roller bearing

Schaeffler ID:  
0002403460000Axial cylindrical roller bearings 811, single  
direction, comprising K811, GS, WS

## Technical information

**Main Dimensions & Performance Data**

d	50 mm	Bore diameter
D	70 mm	Outside diameter
T	14 mm	Height
$C_a$	62,000 N	Basic dynamic load rating, axial
$C_{0a}$	177,000 N	Basic static load rating, axial
$C_{ua}$	17,700 N	Fatigue load limit, axial
$n_G$	4,900 1/min	Limiting speed
$n_{gr}$	1,840 1/min	Reference speed
	0.001 kg	Weight

**Additional information**

	K81110-TV	Axial roller and cage assembly
$D_1$	52 mm	Bore diameter housing washer
	GS81110	Housing Washer
$d_1$	70 mm	Rip diameter shaft washer
	WS81110	Shaft washer
	LS5070	Track Washer
$r_{min}$	0.6 mm	Minimum chamfer dimension

**Mounting dimensions**

$d_{a min}$	68 mm	Minimum diameter shaft shoulder
$D_{a max}$	52 mm	Maximum diameter of housing shoulder
$r_{a max}$	0.6 mm	Maximum recess radius

**Temperature range**

$T_{min}$	120 °C	Operating temperature min.
$T_{max}$	-30 °C	Operating temperature max.